

# REMOTE MONITOR PANEL



Provides an indication of the protection status and audible alarm for the mains protector at the remote location

- ◆ Visual and audible alarm in one unit
- ◆ Self protected from surges and transient overvoltage
- ◆ Compact and light weight
- ◆ Different power cord plug to choose
- ◆ Simple and easy installation
- ◆ Long life and maintenance free



**Visual and audible alarm in one unit** - LEPS Remote Monitor Panel, RMP-05 provides clear visual and audible alarm of your critical surge protector's working condition at a remote location from the computer room. This allows you to respond quickly to any damages, phases loss, power failures of your protector.

**Self protected from surges and transient overvoltage** - RMP-05 has sophisticated built-in hybrid surge protection circuitry for self protection which keeps it working safely even under lightning intense environment.

**Compact and light weight** - The RMP-05 is very compact and light weight which can be easily located at any convenient place near to the service people or easily visible position.

**Different power cord plug to choose** - No matter what kind of power cord plug is required, we have the right one for your power socket.

**Simple and easy installation** - It

can be laid on the table or easily mounted on any flat surface by four screws. A plug-in signal cable for connection between the protector and the unit enable easy installation.

**Long life and maintenance free** - The unit is carefully designed which not only makes it working properly for years but also maintenance free. In the meantime, a Test and Disable switch is included on the panel for ease of testing.

## Installation

For detail installation requirements, pls refer to relevant user manual.

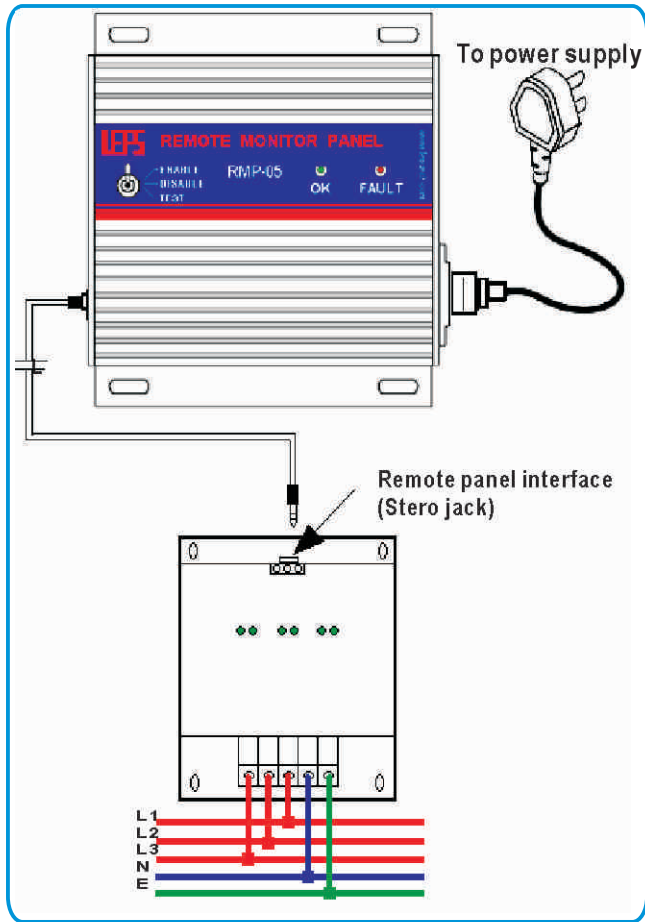

## General Specifications

<b>Nominal working voltage:</b>	100-240V
<b>Max. working voltage:</b>	100V-240±20%
<b>Frequency range:</b>	40-60Hz
<b>Max. surge rating:</b>	16KA (8/20µs)
<b>Current rating:</b>	10mA
<b>Status indicator:</b>	LED (OK=green, Faulty=red)
<b>Audible alarm:</b>	Siren sound
<b>Signal connection port:</b>	3.5mm stereo audio jack
<b>Power connection port:</b>	IEC outlet
<b>Case material:</b>	POM
<b>Operating temperature:</b>	-40-85°C
<b>Humidity:</b>	0-95%(R.H.)
<b>Altitude:</b>	0-3650m
<b>Weight:</b>	950g

## Dimensions

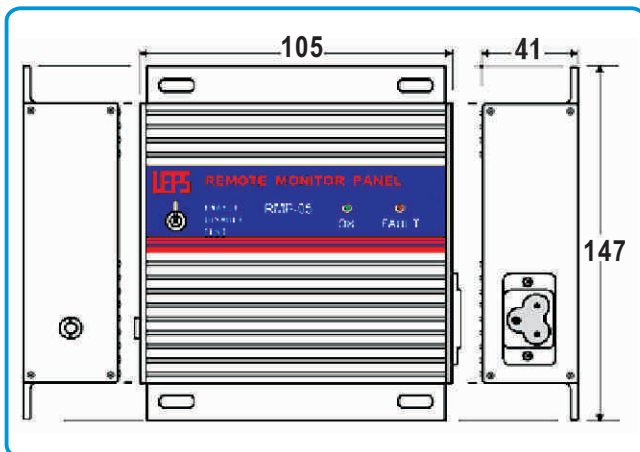

MODEL	PRODUCT DESCRIPTION	PHOTO/DRAWING
RMP-05	Remote monitoring Panel, with LED indication and siren sound	